

For technical support, contact: 011 202 5884 or 083 235 4916.

SMS ALERT 9 ALARM / PLUS User Manual



updated 25 June 2023

Main features

- Arm / Disarm red LED indication & Relay C output for extra pilot LED (12V out)
- Arm / Disarm via KEY switch or remote SMS (Pulse)
- Siren output. Bell squeak (peep).
- 2 Relay outputs. 1 relay can be used for automatic pepper spray for Zone 1 only
- Relay B can be used for **external radio**
- 6 zones, panic, power loss/restore & bypass inputs (8 zones can be ordered, or 12 Zone)
- Bypass input includes, or bypasses last 3 zones
- Silent listen-in microphone
- **Individual Zone on/off via SMS** – new Version 11.2
- 24 hour selectable zones
- **Inputs by default NC, but individual inputs can be changed to NO (mixed)**
- 10 users
- First 5 receive all SMSes, and last 5 receives Panic only (or all users get all SMSes)
- User G is a priority user that gets notified in case of a panic e.g. control room
- Silent zones added (13.2)

(NC default trigger, no terminator resistor must be used, zones renamable)

- | | | | |
|---|--|--|-------------------|
| { | Input 1 | : Zone 1 | |
| | Input 2 | : Zone 2 | |
| | Input 3 | : Power Loss / Power Restore | – Dual state trip |
| { | Input 4 | : Zone 4 | |
| | Input 5 | : Zone 5 | |
| | Input 6 | : Zone 6 | |
| | Input 7 | : Zone 7 | |
| | Input 8 | : Bypass of zones 5,6 and 7. Grounded by default include all zones | |
| | Key Led input: Arm/Disarm the overall system via a positive pulse (<u>WL receiver</u>) | | |
| | Input 9 | : ** Panic ** (NO negative trip) | |



SMS Command Summary

Use **lower case** for all commands sent to the SMS Alert (e.g. 1234 **ap**, 1234 **r**, 1234 **b**, etc.)

Use **UPPER CASE** only with the following 4 commands:

1234 **TC1** (terminate call),

1234 **TC0**

1234 **AIRT** (checking airtime)

1234 **CODE**

Most SMS commands are toggle commands; meaning sending the same SMS command again will undo the command.

SMS command	Default setting	Description
Loading / Cancel users (10 Users)		
1234 b		To let the SMS Alert report to the 1 st phone (toggle). If you SMS <u>1234 b</u> you will <i>load</i> user B. If you SMS <u>1234 b</u> again, you will <i>cancel</i> user B. (In other words you will toggle it on & off). The same SMS gets used every time. There is no user A ! User B is the main user, and indicated by the Yellow/Amber LED on the side. It must be on for inputs to trigger, and for the other users to receive SMS if these users (C,D,E) are loaded. See further down in document for more information.
1234 c		Report to 2 nd phone – use to load and cancel user C (toggle). Same for 1234 d to 1234 k
1234 d		Report to 3 rd phone
1234 e		Report to 4 th phone
1234 f		Report to 5 th phone
1234 g		Report to 6 th phone - Only receives Panic SMSes ! – use 1234 41 to change the setting
1234 h		Report to 7 th phone - Only receives Panic SMSes !
1234 i		Report to 8 th phone - Only receives Panic SMSes !
1234 j		Report to 9 th phone - Only receives Panic SMSes !
1234 k		Report to 10 th phone - Only receives Panic SMSes !
1234 z		Clear/delete all users

General Settings 0		
1234 r		To request the status of the SMS Alert e.g Armed, BC--, #000, #12345678. The SMS Alert will respond with, for example, the following: ARMED B - - - , #0B00 #87650001 ARMED System is armed B- - - User B loaded only. Users C, D and E are not loaded. #0B0 Relay B is switched on. Relay A and C are off # 87650001 Inputs 8,7,6,5 are on / tripped (open).
1234 00	ON	ARM / DISARM SMS notification ON/OFF for the Key Input.
1234 01	OFF	Outgoing missed call function on/off for zone 1 and to user B only.
1234 02	OFF	Relay A will pulse 5 times when zone 1 is tripped. Can be used to trigger a pepper gas dispenser.
1234 03	NC	Change inputs 1-8 between NO and NC – The device will reset – There is no return SMS.
1234 04	ON	Siren ON/OFF for Panic SMS (last input). Can be used for silent Panic.
1234 05	OFF	Advanced setting for use outside of SA. This allows taking the international prefix code into consideration if needed. When set, also send 1234 WC to the SMS Alert. The return



		SMS will contain SET=0111x where x (5th position) must be 1. If it is 0 then send 1234 WC again. This prevents a problem when the network keeps sending an immediate return SMS to the SMS Alert for every SMS the SMS Alert sends out.
1234 06	OFF	Any missed call will pulse Relay A.
1234 07	ON	Siren Bleep ON / OFF when the system is ARMED / DISARMED.
1234 s		Recall status of settings 1234 00 to 1234 07.

General Settings 1		
1234 10	OFF	Bright White Emergency Movement LED Night Light ON/OFF when AC power is OFF and movement is detected on Zone 1. Timeout 4 mins. For Devices fitted with bright LED. – Also enable 1234 13 Note: Relay E won't work correctly if this setting is on
1234 11	OFF	Power Loss Restore SMS ON/OFF for input 3. Used if SMSes are a problem during power outages.
1234 12	OFF	Relay A will pulse 5 times (Spray Peppergas) when Panic is tripped. Similar to 1234 02.
1234 13	OFF	Camera flash for devices fitted with GSM camera device.
1234 14	OFF	Allow 1234 a on and 1234 a off to latch Relay A. By default off to prevent pepper gas dispenser from locking up or getting damaged when 1234 a on is sent by mistake, instead of 1234 ap.
1234 15	OFF	Auto Arm after 1 hour when no movement is detected (all zones must be wired, e.g be closed)
1234 16	OFF	Auto Arm after 1 hour when no movement is detected (all zones does NOT need to be wired)
1234 17	OFF	Changes KEY input to latch mode instead of pulse mode for arm and disarm
1234 v		Recall status of settings 1234 10 to 1234 17.

Individual / mixed Zones between NC and NO		
Used for initial installation to make SMS Alert compatible to sensors/devices		
1234 21	OFF	Change input 1 to NO (Zone 1)
1234 22	OFF	Change input 2 to NO (Zone 2)
1234 23	OFF	Change input 3 to NO (Power Loss / Restore) (Will cause text to swop around)
1234 24	OFF	Change input 4 to NO (Zone 4)
1234 25	OFF	Change input 5 to NO (Zone 5)
1234 26	OFF	Change input 6 to NO (Zone 6)
1234 27	OFF	Change input 7 to NO (Zone 7)
1234 28	OFF	Change input 8 to NO – Bypass input.
1234 w		Recall status of settings 1234 20 to 1234 28.

Individual / mixed Zones ON / OFF		
Used to disable a zone while the alarm is armed e.g. false alarms or indoor sensors while at home		
1234 31	ON	Switch off Input 1 (Zone1)
1234 32	ON	Switch off Input 2 (Zone2)
1234 33	ON	Switch off Input 3 (Power Loss Restore) – Same effect as 1234 11.
1234 34	ON	Switch off Input 4 (Zone4)
1234 35	ON	Switch off Input 5 (Zone5)
1234 36	ON	Switch off Input 6 (Zone6)
1234 37	ON	Switch off Input 7 (Zone7)
1234 38	ON	Switch off Input 8 (Zone8) – May cause zones 5 to 7 to be bypassed – <i>not tested*</i>



1234 x		Recall status of settings 1234 30 to 1234 38.
Other Commands		
1234 41		Allow all inputs to be sent to all users – e.g. the last 5 users will now also receive all SMSes.
1234 42	OFF	Siren on time 5 min vs 1min (default)
1234 43		Change input 9 between Panic and Battery Low (long delay)
1234 44		10 Second delay and siren warning before pepper gas is sprayed unless disarmed. Applicable with 1234 02 is set to automatic.
1234 45	OFF	Bright White Emergency Movement LED Night Light will flash once when armed and twice when disarmed. Sometimes useful at night as an indication when you don't want the loud siren to bleep. To enable/disable the siren bleep use 1234 07 .
1234 46	OFF	Relay B will pulse once when the siren goes off – For external radio trigger
1234 47		Return xxxxxx7x will continue to send out previously triggered zones after a DISARM
1234 48		Return xxxxxx8 will pulse relay B on missed call return xxxxxx_ will pulse relay A on missed call 1234 06 must be activated/enabled. Change pulse to latch via 1234 61
1234 61		Return 1xxxxxx will latch Relay A or B, if -xxxxxx will pulse Relay A or B on Missed call Relay A or B depends on 1234 48.
1234 62	OFF	Secure PUMP switching A: 1234 ap must be sent twice within 5 mins to pulse the relay. Used to securely switching a pump on – (Relay A)
1234 64	OFF	Secure PUMP switching B: 1234 bp must be sent twice within 5 mins to pulse the relay. Used to securely switching a pump on – (Relay B)
1234 63	OFF	Secure PUMP switching: Enable “Timeout” SMS for 1234 62 if second SMS is not received within 5 mins
1234 65	OFF	Disable the KEY input. Arm and Disarm via SMS only
1234 t		Walk-through Test – The siren will bleep when the zones change state.
1234 AIRT		Use the Service Provider APP, 1234 AIRT currently not working on 4G
1234 TC1		Switches auto answer off (TC = Terminate Call).
1234 TC0		Switches auto answer on.
1234 VER		Returns GSM model version and signal strength.
1234 CODE		Changes the code 1234. Will not affect 1234 AIRT, TC1, TC0, VER.
1234 SIREN		Toggle Siren on/off. On time as per 1234 42 setting
24 hour Zones ON / OFF (version 12.0 upwards)		
1234 51	OFF	Zone 1
1234 52	OFF	Zone 2
1234 53	OFF	Unless configured as Power Loss Restore
1234 54	OFF	Zone 4
1234 55	OFF	Zone 5 – input 8 must be grounded if bypass is used
1234 56	OFF	Zone 6 – input 8 must be grounded if bypass is used
1234 57	OFF	Zone 7 – input 8 must be grounded if bypass is used
1234 58	OFF	N/A if not configured as a zone (8)

Silent Zones ON / OFF (version 13.2 upwards)		
	ON = NOT silent	OFF = Silent
1234 71	ON	Zone 1

1234 72	ON	Zone 2
1234 73	ON	Unless configured as Power Loss Restore
1234 74	ON	Zone 4
1234 75	ON	Zone 5 – input 8 must be grounded if bypass is used
1234 76	ON	Zone 6 – input 8 must be grounded if bypass is used
1234 77	ON	Zone 7 – input 8 must be grounded if bypass is used
1234 78	ON	N/A if not configured as a zone (8)
Output Relay Control		
Anyone can operate the relays – you do not need to be a user, but you must know the code e.g. 1234)		
*Relays will not pulse if it is already switched on. First switch it off. Pulse duration is about 1 second. Relays will remember their settings if the unit is re-powered. See further down in document for more information.		
1234 a on		Switch relay A on – see 1234 14
1234 a off		Switch relay A off – see 1234 14
1234 ap		Pulse Relay A <u>once</u> - (For pepper gas purposes)
1234 app		Pulse Relay A <u>10 times</u> – Relay A only (For pepper gas purposes).
1234 b on		Switch relay B on
1234 b off		Switch relay B off
1234 bp		Pulse Relay B once
1234 c on		Switch relay C off, and system disarmed
1234 c off		Switch relay C on, and system armed
1234 cp		Pulse Relay C once – N/A
1234 d on	n/a	Switch relay D on (relay not fitted)
1234 d off	n/a	Switch Relay D off
1234 dp	n/a	Pulse relay D once
1234 e on	n/a	Switch relay E on (transistor output for external relay PCB)
1234 e off	n/a	Switch relay E off
1234 ep	n/a	Pulse Relay E once
1234 all on		Switch all Relays on
1234 all off		Switch all Relays off

Quick Start Steps

1. **Preparing SIM-card** - Buy an MTN, Vodacom or Cell C starter pack (prepaid or contract) and RICA it (you need your id and proof of address for this). Ensure that you can send an SMS out from the SIM-card, before you put it in the SIM-card slot of the SMS Alert. Making a call to the SMS Alert only is not sufficient to test the SIM-card. PIN-code request must be deactivated before you insert the SIM-card into the SMS Alert.
2. **Airtime** - Ensure that the SIM-card has sufficient credit. Load airtime if necessary.
3. **Insert the SIM-card** into the SIM-card slot. Apply 12VDC.



4. SMS **1234 b** from your cellphone to the SMS Alert. Note the **yellow LED** will light up when B is active. This step tells the SMS Alert where to send SMSe when inputs are tripped. **There must be a space between 1234 and b. If you SMS 1234 b again, you will cancel user B. If you SMS 1234 b again, you will reload user B. (In other words you will toggle it on & off).**
5. The SMS Alert will respond to step 5 by sending its status back to you (e.g. ARMED B- - -, #0000 #00000000). Ensure the character "B" appears in the SMS to show user B is loaded. The string means the following:
ARMED System is armed.
B- - - User B loaded only. Users C, D and E are not loaded.
#0000 Relay B is switched on. Relay A and C are off
87650001 Inputs 8,7,6,5 are on / tripped.
Do not confuse the letter B with the letter B under the relays.
6. **Trigger input 1 (Zone 1)** - Apply a continuous negative (NC) to input 1 for about 20 seconds, then remove the negative anytime thereafter and the input will trip. The green LED will go on for 1 second to indicate that a SMS is being sent. You will receive an SMS **Zone 1**. You have just simulated a PIR connected to input 1.
7. **Jumper setting:** -T sets inputs 1 to 8 to negative trip and +T to positive trip required to send SMSe.

How to program the SMS Alert to report to a 2nd, 3rd or 4th cellphone

(ARMED ON B- - -, #0000 #00000000)

VERY IMPORTANT: THE 1ST 5 USERS WILL RECEIVE ALL THE SMS'S. THE LAST 5 USERS WILL RECEIVE PANIC SMS'S ONLY. (SMS ALERT 9 ALARM PLUS VERSION 10.4 AND LATER).

There are 10 users: B,C,D,E,F,G,H,I. Follow step 5 of Quick Start Steps to activate user B which is the first user.

If you want the SMS Alert to report to the 2nd cellphone, SMS **1234 c** from the second cellphone to the SMS Alert. To toggle this feature **off**, SMS **1234 c** again from any cellphone to the SMS Alert.

The last phone that toggled a user **on**, becomes that user.

E.g: **1234 c** (There **must be one space** between **1234** and **c**, and no spaces afterwards. Do the same for **1234 d** (3rd), and **1234 e** (4th). User B must be ON for the other users (if loaded) to also receive SMS messages.

New function to add cellphone numbers:

In conjunction with the current method of loading numbers the following command allow users to be loaded from one point/cellphone. This eliminates the need to send a SMS from each cellphone handset that needs to be added.

When a DOT and phone number is placed after the current command, the phone number will be loaded into that position. The return SMS will be sent to the new cellphone number, not the cellphone number that loads it. You can however check if all the numbers are loaded, by sending **1234 r** to the cellphone number of the SMS Alert.

Example: To load **27821231234** into User B, send the following SMS from one cellphone, to the cellphone number of the SMS Alert:

1234 b.27821231234



(only use 1234 b,c etc., with no phone number if it is not a remote number)

or

1234 e.27821231234

If a user is already loaded, then the command will first delete it (toggle off). It then needs to be sent again. The international setting must be activated for use outside of SA before this can be done (not tested). If it fails, then revert back to the current ol method.

Please keep track which user is loaded as B, C, D etc. Otherwise all users/numbers will be deleted when you want to load or delete users, and you cannot remember which person is assigned as which user.

How to operate the Relay outputs

(INPUT ON B- - -, #0000 #00000000)

The three Relay outputs A, B and C (not the same as users B,C,D,E) can be used for anything that requires remote controlling/switching. For example to switch machinery and equipment on and off or to open a gate, or to switch your alarm on and off. For example to SMS **1234 a on**. There must be one space between **1234** and **a** and **on**.

The alpha characters (a on) must all be lower case. A 4th on-board relay (D) can be added and one external relay.

See command summary on p. 6 on how to control relays.

PLEASE NOTE RELAY C CANNOT BE USED FOR ANYTHING ELSE. ITS PURPOSE IS TO INDICATE IF THE ALARM IS ARMED OR DISARMED VIA A PILOT LED.

Arm / Disarm Methods

Use the key input	Apply a positive 12V pulse to the Key input (NO), for example via a Sherlo <u>receiver</u> .
Via your cellphone (SMS)	Arm - 1234 c on Disarm – 1234 c off Only the sending phone will receive a response back. For all users to receive an Arm / Disarm SMS when armed via SMS, use relay A to pulse the key input. All users must then use 1234 ap for arm and disarm.

*Relay C can be used to light up a LED to indicate if the system is armed or disarmed.

*Relay C is Positive internally connected to the **C Com** connector.

*To make Relay C complete Volt-less “dry contact”, de-solder the 2 solder links at the bottom of the PCB.

Split / Bypass operation (via black loop wire)

Zones 5,6 and 7 can be included or bypassed via input 8, as a group.

When input 8 is negative, all zones e.g. 1-7 will report an alarm event. When input 8 is not negative, zones 5 to 7 are excluded / bypassed and will send an SMS or trip the siren. Input 8 therefore includes/excludes zones 5 to 7 during normal operation.

Auto-Answer (silent listen-in)

This applies to SMS Alerts fitted with a microphone. By default Auto-Answer is on. When you dial the SMS Alert from any cellphone, the unit will ring twice silently, pick up the call and you will be able to hear surrounding



noises via the microphone. To switch off auto-answer (when you don't want someone to listen in) – SMS 1234 TC1 (1 = a digit). To switch it back on SMS 1234 TC0.

Siren

If user B is enabled (yellow LED on) and the unit is armed, the siren output will trigger for 1 minute and then reset. E.g. the siren will switch off (time-out) after 1 minute or if the system is disarmed. The siren will **switch off** when a call is made to listen in.

Loading & checking airtime balance

SMS COMMANDS	FUNCTION	SMS TO BE SENT TO SMS ALERT
Vodacom	Account balance	1234 AIRT*136#
Vodacom	Check Bundle SMS balance	1234 AIRT*111*502#
Virgin	Check balance (Prepaid)	1234 AIRT*101#
Virgin	Check balance (Contract)	1234 AIRT*102#
Cell C	Check Balance	1234 AIRT*101#
DIAL COMMANDS	FUNCTION	NUMBER TO DIAL
Vodacom	Please call me	*140*number#
Vodacom	What is my number	*135*501#
Vodacom :	Balance	*136#
MTN	Balance	*136#
MTN	What is my number	*123*888#

Airtime on prepaid SIM-cards can also be checked by registering the cellphone number of the SMS Alert on www.vodacom4me.co.za (for vodacom) or the applicable Service Provider's website.

Airtime can also be loaded via internet banking, an ATM, or by removing the SIM-card and putting it in your own personal phone using the voice method.

****Disconnect the power from the SMS Alert when the SIM-card is removed.**

SMS Alert Cellphone App (currently only for Android phones)

To download our SMS Alert app to your cellphone (currently only Android phone), please visit our web site at www.smsalert.co.za. On the left-hand side of the home page, underneath the SMS Alert logo, there is a link you can follow. Please note the link must be followed with your cellphone (not your PC), to download it to your cellphone.

Because it is a new app, it is not yet available from the Google Play store.

An app for iPhones is being developed.

General information

1	Panic Input	24h active – User B must be loaded.
2	Key Input	Arms and disarms all the zones.
3	Green LED	Indicates when the SMS Alert is sending an SMS. The LED will stay on for 3 seconds. If the light is flashing, a problem exists. See troubleshooting. After 2 minutes the SMS Alert will attempt to reset the flashing LED.

4	Yellow LED	Indicates user B is active, and the SMS Alert will at least report to user B. User B is the main user, and if it is off, C, D and E won't work even if they were toggled on.
5	Red LED	Indicates if the system is armed or disarmed.
6	SIM-card type	When last tested, the SMS Alert accepts MTN, Vodacom or CellC SIM-cards. contract or prepaid.
7	Finding out what the cellphone number of the SMS Alert is	Put the SIM-card of the SMS Alert into your cellphone and dial the following numbers: MTN: *123*888# Vodacom: *111*501# Telkom / 8ta: *1# Cell C: *147*100#

Technical Specifications

1	Power supply	9 - 14VDC volt DC, 500mA (milliamps). An in-line batter is preferred for smooth power. Power supply must be doubled-up.
2	Power consumption	Standby current 30 – 50mA, 400mA peak when SMS is send or received.
3	Users	The inputs can report to up to 4 users B,C,D and E.
4	Relay contacts	10A / 124VAC – It is not recommended to switch 220VAC unless you are a certified electrician.
5	Inputs	Inputs 1 – 8 optically isolated and negative or positive trip selectable via jumper. The Panic input can only be tripped negatively. Rename another input to Panic if only a positive signal is available. Input 3 is a dual state input – It trips on both signal conditions. Inputs are buffered control for simultaneous triggering. Key input – NO positive pulse trip.
6	Siren output	1.5 A transistor emitter output.

Fault finding / Troubleshooting

1	No or bad cell phone signal	Ensure the SIM-card holder contacts are clean. Use an earbud. Try to use an external aerial (available from supplier).
2	Flashing green LED	Re-power the SMS Alert system. This happens when the SMS Alert's power is connected (reset) three times in a short period. The automatic reset recovery is then disabled to protect the phone until power is removed and applied again. The SMS Alert will also attempt to reset itself after 2 minutes.
3	Other equipment used in conjunction with SMS Alert	It is not recommended that other receivers, transmitters or equipment be kept inside the SMS Alert box.
4	Ad-hoc behaviour	Ensure that a very good / smooth Power Supply Unit (PSU), or power from the alarm panel is used where florescent tubes or machinery are not in the proximity of the SMS Alert. Auxiliary outputs on panels do not provide sufficient power.
5	The green light goes on but no SMS is received	Ensure the SIM-card is properly registered. Insert the SIM-card in your own personal phone and call e.g. MTN (141) or Vodacom (100) to clarify the problem. Check your airtime. Make sure you can manually send a SMS.
6	Resetting the system	Disconnect and reconnect the power from the SMS Alert. The unit can unfortunately no be defaulted.

Antennas for poor reception:



3 meter Antenna available for external GSM reception, or poor reception

Inserting the SIM-card on the PC Board

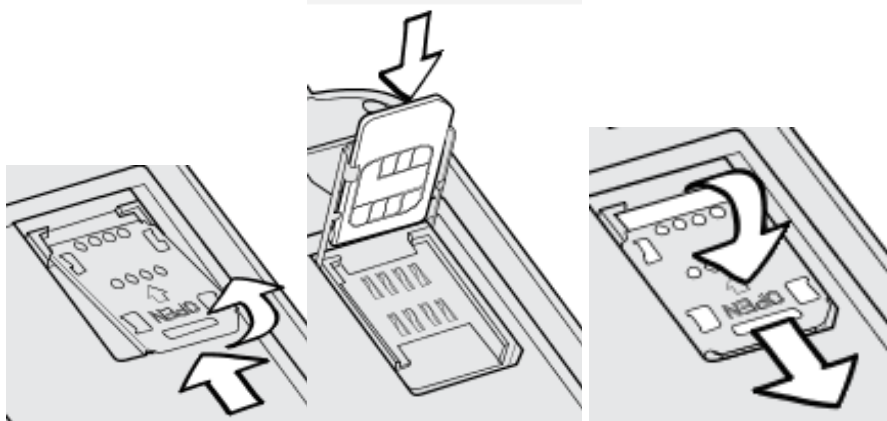

A

B

C

1. A - Push/slide flap in the same direction as the board (about 1- 2 mm).
2. A - The flap will unlock, lift the flap.
3. B - Insert SIM-card.

Diagram for GSM Module PC Board (where SIM-card slots in)

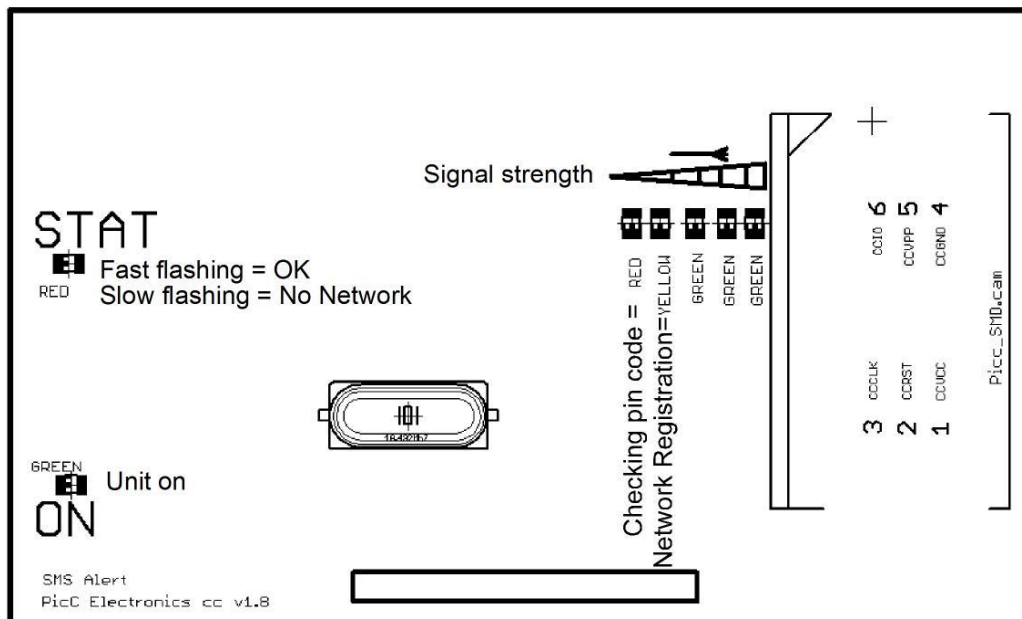

SMS 1234 AIRT for prepaid airtime balance. Does not report bundle SMS balance. South Africa only.

1. You don't have to have an existing alarm panel to connect this unit to; it can function on its own (use SMS Alert 9 if you have an existing alarm panel)
2. Do not connect the power of the SMS Alert to an **auxiliary 12V power output**. It is best to connect the SMS Alert **directly to, and within 1 meter from the 12V battery** where the power is best regulated.
3. External magnetic antennas are available for **better reception**. It may be required where the signal reception is poor, or where the system is installed in a metal container that prevents signal reception.
4. Try to keep the SMS Alert at least **30cm** away from other equipment like **receivers, transformers, energisers**, etc., that may cause interference.
5. It is strongly recommended that **Mylar cable** (shielded with foil) is used for **Electric Fence** applications. Both the power and inputs on the SMS Alert must use Mylar cable. Without this cable the SMS Alert might seem to work fine, but problems may be experienced 2 weeks later. Also ensure **high voltage wires** do not cross the SMS Alert wires.
6. The SMS Alert should work **outside of SA**, however limited testing was done for this purpose.
7. The SMS Alert is **not built for a specific alarm panel** and may have other applications like pump control and monitoring, cable theft, electric fence monitoring, opening/closing a gate, etc.
8. In very few cases, when SMS commands are **not recognised by the SMS Alert**, check that the user's Text Message settings on his/her cellphone are set to 'Text mode' or 'Full Character Support' (under message options).
9. It is recommended that the SMS Alert be **tested** on a regular basis, for example by sending it a status request (1234 r). This will also cause a transaction that may prevent the SIM-card from expiring if it is seldom used.
10. Always keep the inside of the **SMS Alert box clean**, with the minimum amount of unnecessary wires.
11. Do not apply **excessive force** with tools on the connector terminals to prevent break-offs.
12. To keep your number active, you should send an SMS (1234 r) at least once **every 7 months (Vodacom) or 3 months (MTN)**, or as specified by your cellphone service provider.



***NOTE:** A DATA option via an APP, with monthly auto SIM loading (Android only) is available at R99/month per device when SMSes cost are too much. The data option also allows for multiple switching and monitoring of SMS Alerts, logging etc. Also for M2M, where one SMS Alert switches many SMS Alerts on/off.*

Almost an unlimited users can be notified. SMS can still function as normal as a fallback if required.

Support:

1. Additional requests can also be emailed to info@smsalert.co.za.
2. For software/hardware updates, please visit www.smsalert.co.za.
3. **For support, phone us on 083 235 4916.** Please note that your first point of call must be your supplier or installer. If they are unable to help you, we will be more than happy to assist.

Disclaimer:

PicC Electronics will not be held responsible for loss, damage or injury to any persons, company or legal entity using PicC Electronics products or for GSM Network changes or reliability. There is no guarantee that SMS's will always go through. It is recommended that a prepaid SIM-card is used, or that a process is in place to cancel or stop the SIM-card, or to limit SMS's - should a malfunction occur where many SMS's are sent and unforeseen costs are incurred. It is recommended to test your SMS Alert on a regular basis. A product of PicC Electronics must be installed by an installer trained by PicC Electronics or with relevant installation experience.

SMS Alert 9 Alarm Plus - Wiring Diagram

Walk Through Test
 SMS 1234 t and the siren will beep when the zones change state.

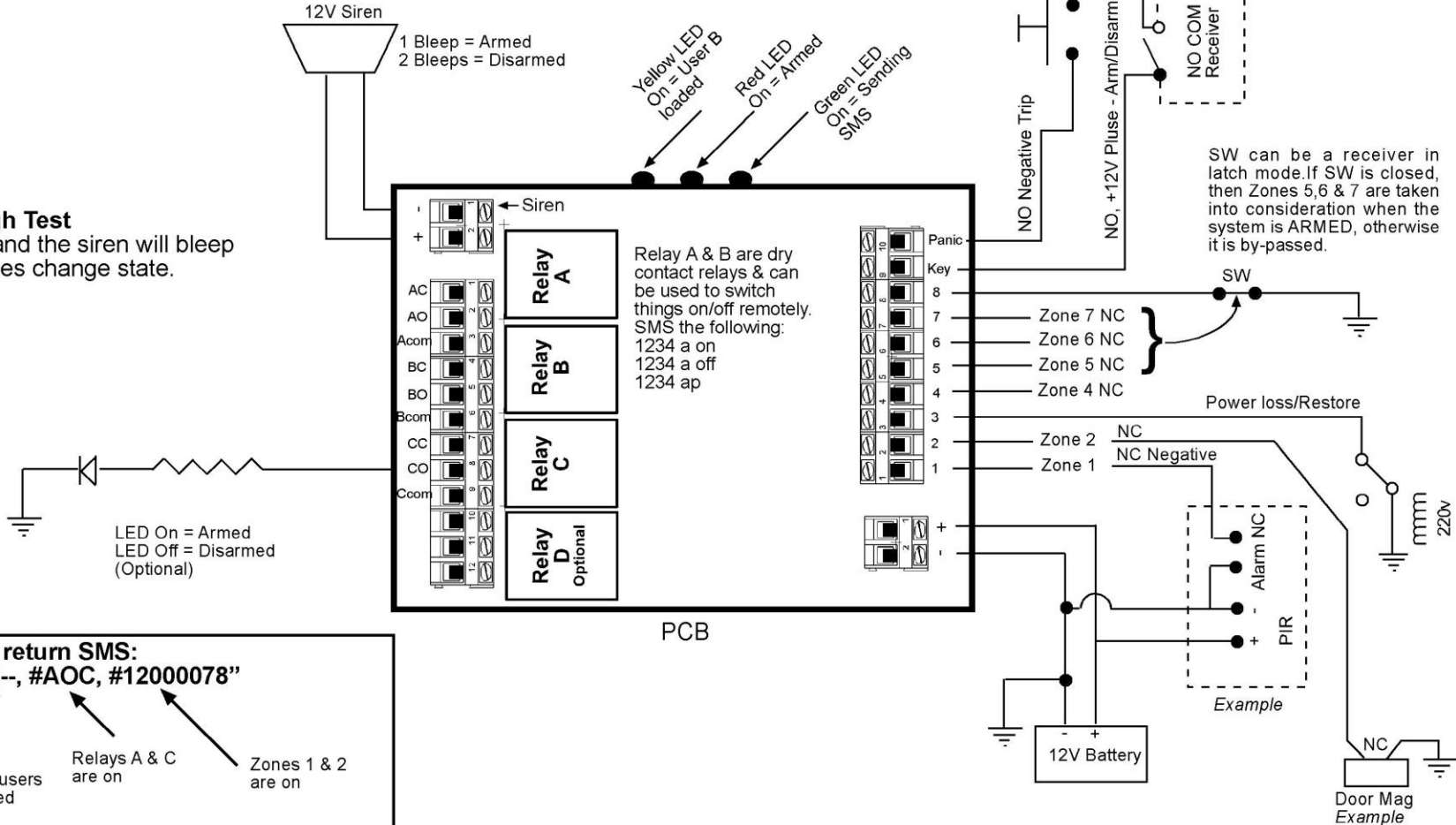

Meaning of return SMS:
 'Armed, BC--, #AOC, #1200078'

System armed
 Two users loaded
 Relays A & C are on
 Zones 1 & 2 are on

- Relay C is dedicated for a pilot LED only.
- There are soldier joints under the PCB if you don't want 12V to go through the relay.
- CO is connected to 12V internally and will switch on if the system is armed.

The zones will trip when a closed circuit (NC) is applied for at least 30 seconds and the circuit is then broken. This prevents multiple SMS's being sent when an alarm goes off.

